

16th & 17th March 2010

The Hydro Hotel, Bowness

### Exhibitor Booking Form

Please complete and return along with your deposit cheque, to the Lakes Hospitality Association, Windermere Business Centre, Oldfield Court, Windermere, LA23 2HJ. T: 015394 44495. F: 015394 44495. E: info@lakeshospitality.co.uk  
Please note that this is the information that will be printed in the event programme, so please ensure data is accurate.

Company Name :

Contact Name :

Address :

Postcode :

Telephone :  Fax :

Email :  Web :

Stands will initially be allocated on a first-come-first-served basis, but we reserve the right to appropriately re-locate stands as required, to ensure that the full potential of the marquee and hotel is realised

#### HOTEL STAND BOOKINGS

The hotel is open to TRADE visitors only and exhibitors from all types of business are welcome to exhibit in here

	Stand Number	Tot cost ex VAT
First choice	<input type="text"/>	<input type="text"/>
Second Choice	<input type="text"/>	<input type="text"/>

#### Equipment Requirements

	Cost Each	Quantity	Tot cost ex VAT
Dbl electric socket	£30	<input type="text"/>	<input type="text"/>
6ft table	£10	<input type="text"/>	<input type="text"/>

Please list all electric / gas / cooking equipment that you will be bringing, with details of the wattage that will be required. Please note that the listing of this equipment is important so that you are not charged any additional fees for work carried out during set-up

Item	Wattage
<input type="text"/>	<input type="text"/>
<input type="text"/>	<input type="text"/>
<input type="text"/>	<input type="text"/>

#### Advertising Requirements

	Cost each	Tot cost ex VAT
1/2 page ad in programme	£50	<input type="text"/>
Company listing (25-30 words)	FOC	£0.00
Please enter company Description here:	<input type="text"/>	

Tot cost ex VAT	<input type="text"/>
Tot cost inc VAT @ 17.5%	<input type="text"/>
Less deposit (min £100)	<input type="text"/>
Balance due by 29th Jan 2010	<input type="text"/>

#### MARQUEE STAND BOOKINGS

The marquee is open to both TRADE and visitors from the GENERAL PUBLIC. The marquee is predominantly for exhibitors related to food, drink, local produce and attractions

	Stand Number	Cost ex VAT @ £100 per sq m
First choice	<input type="text"/>	<input type="text"/>
Second Choice	<input type="text"/>	<input type="text"/>

#### Equipment Requirements

	Cost Each	Quantity	Tot cost ex VAT
Dbl electric socket	£30	<input type="text"/>	<input type="text"/>
6ft x table	£10	<input type="text"/>	<input type="text"/>

Please list all electric / gas / cooking equipment that you will be bringing, with details of the wattage that will be required. Please note that the listing of this equipment is important so that you are not charged any additional fees for work carried out during set-up

Item	Wattage
<input type="text"/>	<input type="text"/>
<input type="text"/>	<input type="text"/>
<input type="text"/>	<input type="text"/>

#### Advertising Requirements

	Cost each	Tot cost ex VAT
1/2 page ad in programme	£50	<input type="text"/>
Company listing (25-30 words)	FOC	£0.00
Please enter company Description here:	<input type="text"/>	

Tot cost ex VAT	<input type="text"/>
Tot cost inc VAT @ 17.5%	<input type="text"/>
Less deposit (min £100)	<input type="text"/>
Balance due by 29th Jan 2010	<input type="text"/>

Sign :  Print :

Date :

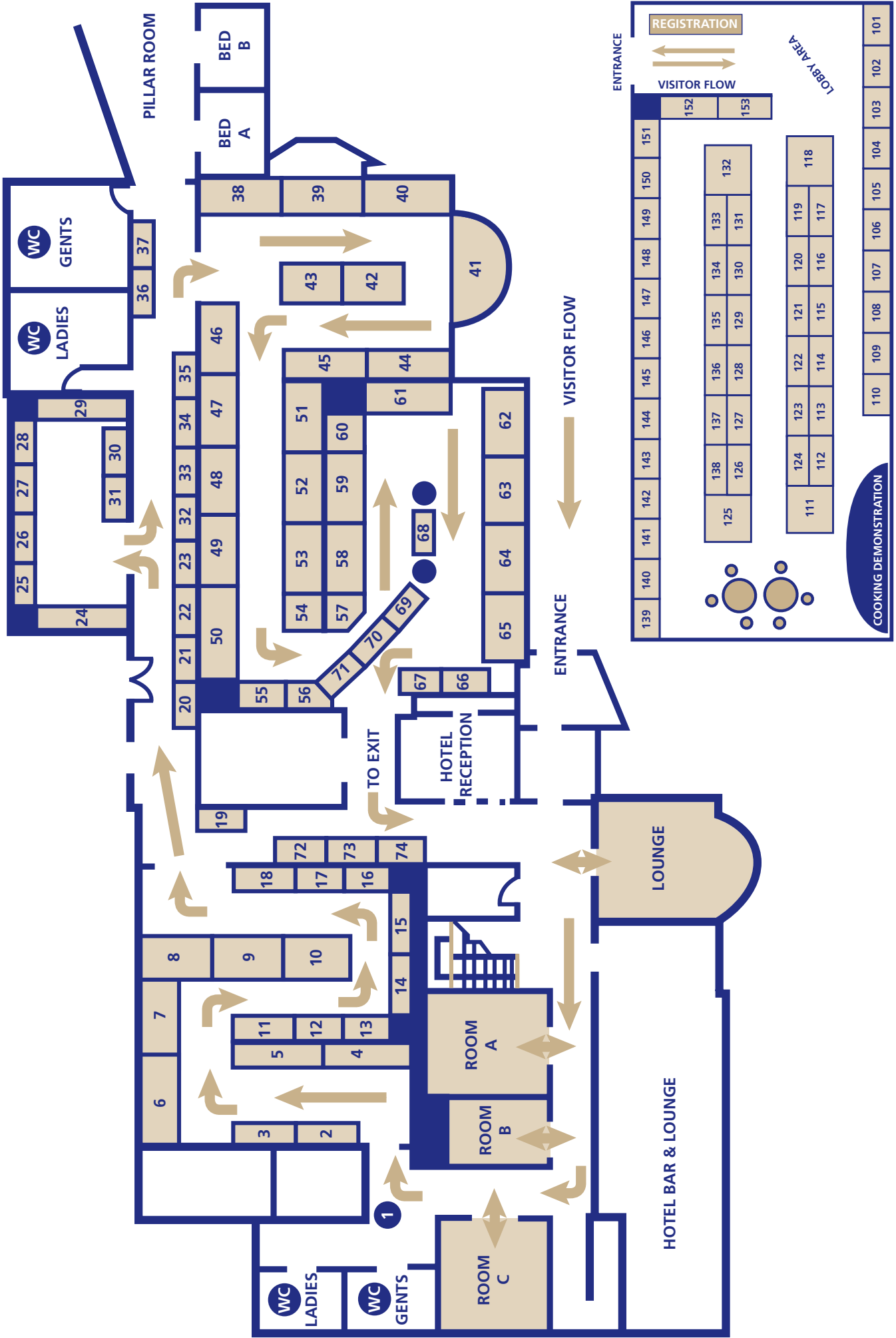

Stands 111, 118, 125 and 132 are 3m x 2m  
 Other stands are 2m x 1m or 3m x 1m.  
 Location of these stands is fairly flexible.

## EXHIBITOR RATES

### HOTEL Stand Tarriff

Stand No	Size l x d	Area sq. mts	Cost (ex VAT) £
1	2x1	2	£250.00
2	4x1	4	£580.00
3	4x1	4	£550.00
4	3x1	3	£410.00
5	3x1	3	£410.00
6	4x2	8	£1,100.00
7	3x2	6	£850.00
8	3x2	6	£850.00
9	3x2	6	£850.00
10	3x2	6	£900.00
11	2x1	2	£300.00
12	2x1	2	£300.00
13	3x1	3	£400.00
14	3x1	3	£450.00
15	3x1	3	£450.00
16	3x1	3	£450.00
17	2x1	2	£350.00
18	2x1	2	£350.00
19	2x1	2	£300.00
20	2x1	2	£300.00
21	2x1	2	£300.00
22	2x1	2	£300.00
23	2x1	2	£300.00
24	2x1	2	£300.00
25	2x1	2	£300.00
26	2x1	2	£300.00
27	2x1	2	£300.00
28	3.5x1	3.5	£475.00
29	2x1	2	£280.00
30	2x1	2	£280.00
31	2x1	2	£280.00
32	2x1	2	£280.00
33	3.5x1	3.5	£475.00
34	2x1	2	£310.00
35	2x1	2	£310.00
36	2x1	2	£300.00
37	2x1	2	£260.00
38	3x2	6	£850.00
39	3x2	6	£850.00
40	3x2	6	£850.00
41	2.5x2	5	£750.00
42	2.5x2	5	£700.00
43	4x2.5	10	£1,500.00

Stand No	Size l x d	Area sq. mts	Cost (ex VAT) £
44	3x1.5	4.5	£750.00
45	4x1.5	6	£800.00
46	3x2	6	£800.00
47	3x2	6	£800.00
48	3x2	6	£800.00
49	3x2	6	£800.00
50	4.5x2	9	£1,300.00
51	2x1.5	3	£450.00
52	2x1.5	3	£450.00
53	3x2	6	£800.00
54	3x2	6	£800.00
55	3x2	6	£800.00
56	2x2	4	£550.00
57	2x2	4	£550.00
58	3x2	6	£800.00
59	3x2	6	£800.00
60	2x2	4	£550.00
61	2x1.5	3	£450.00
62	3x2	6	£800.00
63	3x2	6	£800.00
64	3x2	6	£800.00
65	3x2	6	£800.00
66	2x1	2	£350.00
67	2x1	2	£350.00
68	2x1	2	£350.00
69	2x1	2	£350.00
70	2x1	2	£350.00
71	2x1	2	£350.00

### HOTEL Exhibition Room Tarriff

Room No	Area sq. mts	Cost (ex VAT) £
A	10	£750.00
B	8	£550.00
C	18	£1,500.00
D	15	£1,200.00
Lounge		£2,000.00

### MARQUEE Tarriff

Room No	Cost per sq m (ex VAT) £
All areas	£100